



Franklin Elementary School

Franklin-McKinley School District has delivered quality education dating back to 1868 when it is reported that they opened the doors of their first school. Recently, when they recognized the need for facility modernization, they opted for modular delivery to not only improve the facilities with modern instructional delivery, but also provide the opportunity to reduce energy and water consumption, improve air quality and increase natural lighting.

The District worked with Enviroplex to deliver a state-of-the-art kindergarten building as well as classroom wings and an administration building on their Franklin Elementary School Campus. In partnership with Sugimura Finney Architects, the buildings were designed with elevated ceilings and oversized glazing to allow for an abundance of natural light. Completed in the fall of 2017, the new buildings consist of 24,640 square feet of new space suitable for today's advanced educational environments.



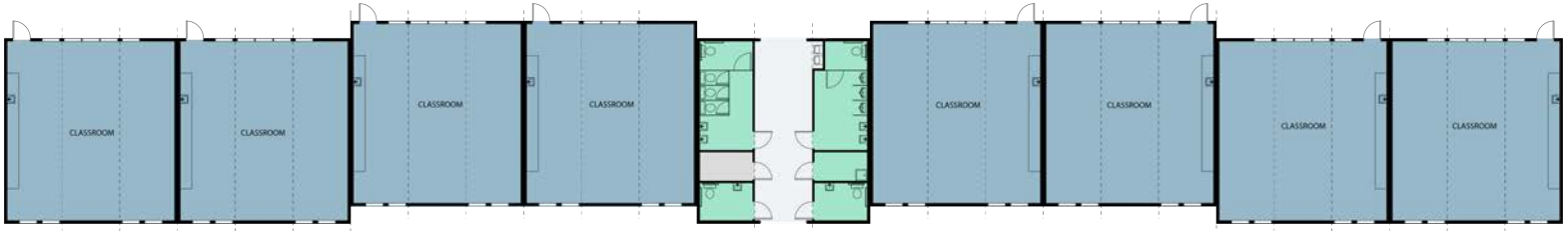
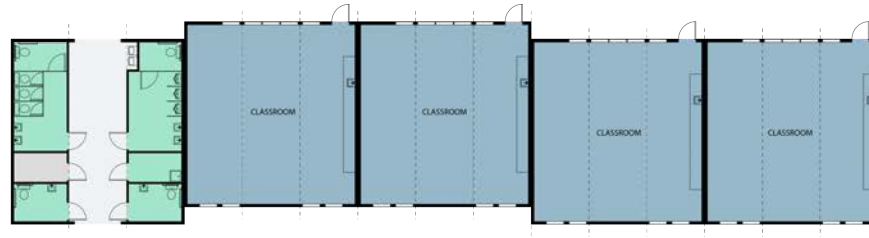

Key Building Features

- 10' finished floor to ceiling height
- Concrete sub-floors
- High-efficiency LED lighting
- Detached 2:12 bi-pitched roof w/ 5' overhangs
- Custom colored roof panels
- Staggered, off-set modules
- Commercial grade, high-efficiency windows
- Centralized multi-fixture restroom with integrated over-framed tower feature
- Individually controlled HVAC mini-split systems
- 3-coat stucco with thin brick veneer accent
- Premium wall coverings



Classroom Building Features

- Interior high efficiency 2-stage HVAC units
- Custom Learning Walls
- Built in casework and plumbing for sinks within each classroom