



Tamarack Elementary School

Located in California's Central Valley, the Reef-Sunset Unified School District serves a diverse student population, many from underserved backgrounds. Tamarack Elementary School, situated in the city of Avenal, faced rising enrollment and a critical need for additional classroom space to support the district's growing early education programs, particularly transitional kindergarten (TK) and kindergarten.

To meet this need, Enviroplex collaborated with the district to deliver a high-impact modular solution tailored for young learners. The project consisted of five modular classroom buildings: four 72'x40' kindergarten classrooms and one 36'x40' TK classroom. Each classroom was thoughtfully designed to foster safe, engaging, and age-appropriate learning environments.

The modular buildings featured early education-friendly layouts with integrated restrooms, safety-focused entry points, and energy-efficient mechanical systems. Strategically installed to maximize limited site space, the buildings allowed the district to expand capacity without disrupting existing campus operations.

Throughout the project, Enviroplex worked closely with the district's facilities team to navigate tight timelines, delivery logistics, and coordination with vendors. The result was a seamless deployment of high-quality learning spaces that now support hundreds of young students in their formative academic years.

This expansion of Tamarack Elementary School represents more than just additional square footage—it's an investment in the future of a community that deeply values education. The new classrooms have transformed the campus atmosphere, giving students and educators the room and resources to thrive.



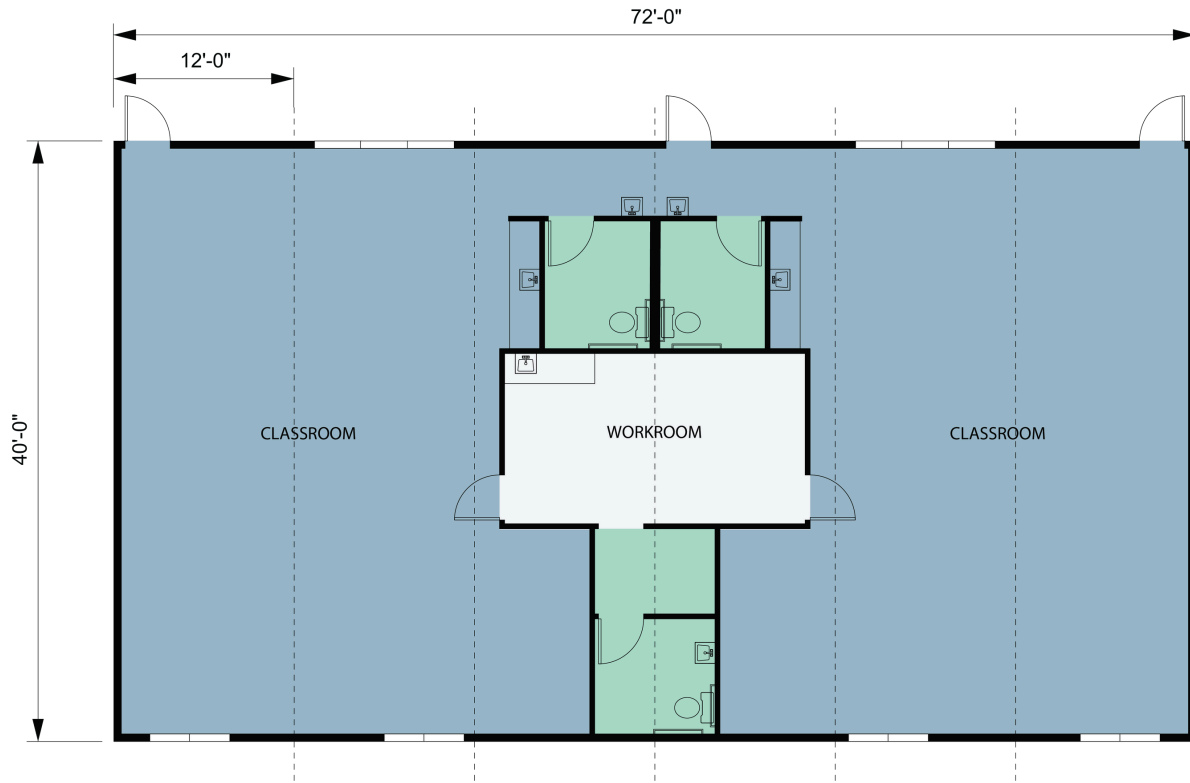

Key Building Features

- Modular construction
- Energy-efficient systems
- Age-appropriate amenities for TK and Kindergarten students
- Custom classroom layouts for early learners
- Safe and efficient installation on an active campus



Project Scope and Size

- Four 72'x40' modular kindergarten classrooms
- One 36'x40' modular transitional kindergarten classroom
- Total of five buildings